

Green Pin® Lifting Eye GR8

Grade 8 lifting eye

- **Material:** alloy steel, grade 8, quenched and tempered
- **Safety factor:** MBL equals 5 x WLL
- **Finish:** painted red or white
- **Temperature range:** -40°C up to +200°C
- **Certification:** 2.1 2.2 3.1 MPI[®] CE



AL

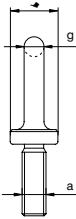
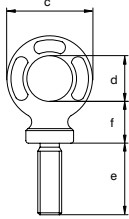

| working load limit | diameter thread | diameter base | diameter eye outside | diameter eye inside | length | thickness base | diameter | weight each |
|--------------------|-----------------|---------------|----------------------|---------------------|--------|----------------|----------|-------------|
| t | a mm | b mm | c mm | d mm | e mm | f mm | g mm | kg |
| 0.2 | M6 x 1.00 | 20 | 34 | 20 | 20 | 17 | 7 | 0.05 |
| 0.4 | M8 x 1.25 | 20 | 34 | 20 | 24 | 17 | 7 | 0.07 |
| 0.7 | M10 x 1.50 | 20 | 38 | 22 | 30 | 19 | 8 | 0.08 |
| 1 | M12 x 1.75 | 25 | 47 | 27 | 36 | 23 | 10 | 0.14 |
| 1.2 | M14 x 2.00 | 30 | 57 | 30 | 40 | 27 | 14 | 0.25 |
| 1.5 | M16 x 2.00 | 36 | 63 | 35 | 53 | 31 | 14 | 0.39 |
| 2 | M18 x 2.50 | 36 | 63 | 35 | 53 | 31 | 14 | 0.38 |
| 2.5 | M20 x 2.50 | 40 | 72 | 40 | 58 | 34 | 16 | 0.58 |
| 3 | M22 x 2.50 | 42 | 82 | 45 | 64 | 38 | 19 | 1.01 |
| 4 | M24 x 3.00 | 55 | 95 | 55 | 84 | 40 | 20 | 1.12 |
| 5 | M27 x 3.00 | 55 | 95 | 55 | 84 | 40 | 20 | 1.18 |
| 6 | M30 x 3.50 | 60 | 108 | 60 | 99 | 49 | 24 | 1.84 |
| 7 | M33 x 3.50 | 60 | 108 | 60 | 99 | 49 | 24 | 2.01 |
| 8 | M36 x 4.00 | 65 | 118 | 68 | 117 | 47 | 25 | 2.44 |
| 9 | M39 x 4.00 | 65 | 118 | 68 | 117 | 47 | 25 | 2.62 |
| 10 | M42 x 4.50 | 70 | 142 | 80 | 135 | 61 | 31 | 5.41 |
| 15 | M45 x 4.50 | 70 | 142 | 80 | 135 | 61 | 31 | 4.16 |
| 18 | M48 x 5.00 | 95 | 181 | 97 | 150 | 68 | 42 | 8.22 |
| 20 | M52 x 5.00 | 95 | 181 | 97 | 150 | 68 | 42 | 8.55 |
| 25 | M56 x 5.50 | 95 | 181 | 97 | 150 | 68 | 42 | 8.85 |
| 30 | M60 x 5.50 | 95 | 181 | 97 | 150 | 68 | 42 | 9.16 |
| 36 | M64 x 6.00 | 95 | 181 | 97 | 150 | 68 | 42 | 9.55 |