



## Green Pin® Eye Nut GR8

### Grade 8 eye nut



EL

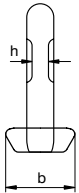
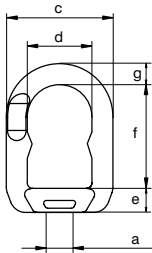

- **Material:** alloy steel, grade 8, quenched and tempered
- **Safety factor:** MBL equals 5 x WLL
- **Finish:** painted red or white
- **Temperature range:** -40°C up to +200°C
- **Certification:** 2.1 2.2 3.1 MPI<sup>1</sup> CE

working load limit	diameter thread	diameter base	width	width inside	thickness base	length inside	diameter	thickness	weight each
t	a mm	b mm	c mm	d mm	e mm	f mm	g mm	h mm	kg
0.2	M6 x 1.00	31	51	30	14	44	11	6	0.15
0.4	M8 x 1.25	31	51	30	14	44	11	6	0.15
0.7	M10 x 1.50	31	51	30	14	44	11	6	0.15
1	M12 x 1.75	39	56	32	15	48	12	6	0.29
1.2	M14 x 2.00	39	56	32	15	48	12	6	0.29
1.5	M16 x 2.00	44	65	37	16	60	14	8	0.38
2	M18 x 2.50	44	65	37	16	60	14	8	0.38
2.5	M20 x 2.50	44	65	37	16	60	14	8	0.38
3	M22 x 2.50	52	79	48	21	75	16	11	0.63
4	M24 x 3.00	52	79	48	21	75	16	11	0.63
5	M27 x 3.00	52	79	48	21	75	16	11	0.63
6	M30 x 3.50	66	96	58	25	88	21	14	1.11
7	M33 x 3.50	66	96	58	25	88	21	14	1.11
8	M36 x 4.00	84	121	73	39	100	25	17	2.22
9	M39 x 4.00	84	121	73	39	100	25	17	2.22
10	M42 x 4.50	84	121	73	39	100	25	17	2.22
15	M45 x 4.50	90	132	82	42	121	25	22	2.73
18	M48 x 5.00	90	132	82	42	121	25	22	2.73