

C

Thimbles

Standard commercial

- **Material:** mild steel
- **Finish:** electro-galvanized
- **Certification:** 2.1



E-6110

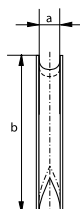
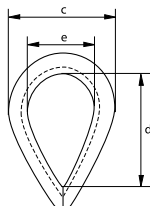

diameter rope	width groove	length	width	length inside	width inside	weight per 100 pcs
mm	a mm	b mm	c mm	d mm	e mm	kg
3	3	24	18	15	10	0.4
4	4	25	19	16	11	0.5
5	5	31	22	22	16	0.8
6	6	37	29	26	19	1.4
8	8	51	38	34	24	2.8
9	9	57	42	38	29	3
10	10	64	44	42	32	4.8
11	11	70	51	48	35	7.5
12	12	76	57	51	38	8
14	14	82	60	57	40	10
16	16	89	64	60	42	15
18	18	102	69	67	45	22
20	20	115	79	76	51	25
22	22	127	89	83	54	32
24	24	140	102	88	64	46
26	26	152	105	102	68	66
28	28	165	115	110	73	77
30	30	178	121	115	79	80
32	32	203	133	140	93	130

C

Thimbles

Heavy duty stub-end

- **Material:** mild steel
- **Finish:** hot dipped galvanized
- **Certification:** 2.1



G-6120

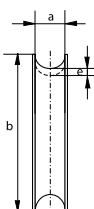
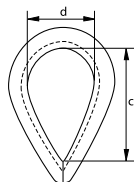

diameter rope	width groove	length	length inside	width inside	thickness back	weight per 100 pcs
mm	a mm	b mm	c mm	d mm	e mm	kg
8	9	51	37	23	4	6
10	11	64	53	31	4	7
12	13	76	60	36	5	14
14	15	89	68	46	6	22
16	17	102	79	51	6	24
18	19	114	90	55	8	43
20	21	127	98	62	9	65
22	23	140	112	67	10	93
24	25	152	119	72	10	102
28	29	178	135	82	10.5	135
32	33	203	163	102	10.5	162
36	37	229	185	117	12	363
40	42	254	205	122	12	376
44	46	280	220	133	15	608
50	52	305	221	143	20	960
56	58	356	252	163	20	1400
64	67	407	286	185	20	1700